

ISO taper hydraulic chucks HMC 3000 for clamping small diameters

Product information

- perfect concentricity:
< 3 µm at 10xd1
- balancing quality: G6.3 / 30,000 rev./min
- ISO taper to DIN 69871 form AD/B
- high clamping force
- quick, simple handling and accurate length setting
- IC and GÜHROJET peripheral cooling ensure optimal chip evacuation and tool lubrication

Scope of delivery

- incl. length adjustment screw
- incl. hexagon chuck key Guhring no. 4912
- order pull studs Guhring no. 4925, 4926 separately

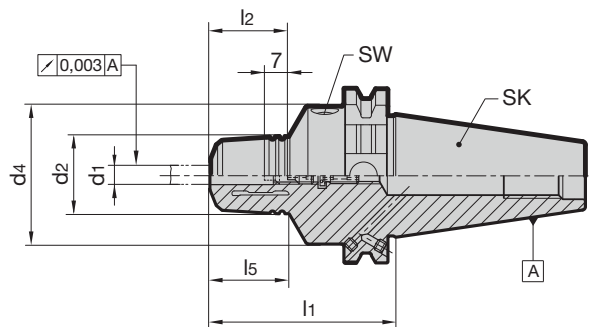

Series Number

4619

ISO taper	for shank Ø d _{1 h6} mm	d ₂ mm	d ₄ mm	l ₁ mm	l ₂ mm	l ₅ mm	SW	Order Code	EDP Numbers
40	3	28	49.5	84.5	34	34	5	3.040	9046190030400
40	4	28	49.5	84.5	34	34	5	4.040	9046190040400
40	5	28	49.5	84.5	34	34	5	5.040	9046190050400