

ISO taper hydraulic chucks with increased clamping force

Product information

- ISO taper to DIN 69871 form AD/B
- form B supplied with threaded pins in bores
- balancing quality: G6.3 / 15,000 rev./min
- axial length setting
- for tool shank tolerance h6

Scope of delivery

- incl. adjustment screw Guhring no. 4900
- incl. hexagon chuck key Guhring no. 4912
- order pull studs Guhring no. 4925, 4926 separately

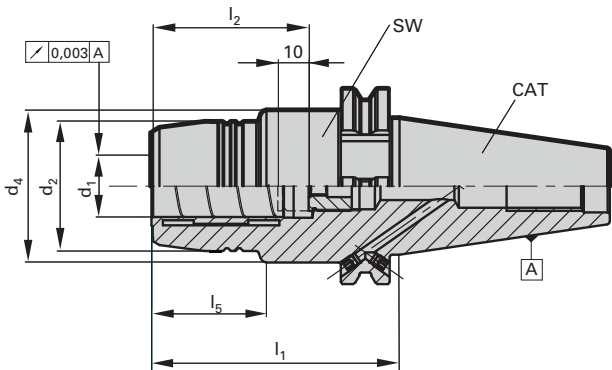

Series Number **4213**

| ISO taper | for shank Ø d ₁ h ₆ mm | d ₂ mm | d ₄ mm | l ₁ mm | l ₂ mm | l ₅ mm | incl. setting screw 4900 ... | SW | kg | Order Code | EDP Numbers |
|-----------|---|----------------------|----------------------|----------------------|----------------------|----------------------|---------------------------------|----|------|---------------|---------------|
| 40 | 6 | 26 | 49.5 | 80.5 | 37 | 29.5 | 904900060140 | 5 | 1.50 | 6.040 | 9042130060400 |
| 40 | 8 | 28 | 49.5 | 80.5 | 37 | 30 | 904900080140 | 5 | 1.50 | 8.040 | 9042130080400 |
| 40 | 10 | 30 | 49.5 | 80.5 | 41 | 31 | 9049000100140 | 5 | 1.50 | 10.040 | 9042130100400 |
| 40 | 12 | 32 | 49.5 | 80.5 | 46 | 31.5 | 9049000120140 | 5 | 1.50 | 12.040 | 9042130120400 |
| 40 | 14 | 34 | 49.5 | 80.5 | 46 | 31.5 | 9049000120140 | 5 | 1.50 | 14.040 | 9042130140400 |
| 40 | 16 | 38 | 49.5 | 80.5 | 49 | 33 | 9049000160140 | 5 | 1.50 | 16.040 | 9042130160400 |
| 40 | 18 | 40 | 49.5 | 80.5 | 49 | 33 | 9049000201140 | 5 | 1.50 | 18.040 | 9042130180400 |
| 40 | 20 | 49.5 | 49.5 | 64.5 | 51 | - | 9049000201140 | 6 | 1.50 | 20.040 | 9042130200400 |
| 40 | 20 | 42 | 49.5 | 80.5 | 51 | 34 | 9049000201140 | 6 | 1.50 | 20.140 | 9042130201400 |
| 40 | 20 | 42 | 49.5 | 110 | 51 | 34 | 9049000200140 | 6 | 2.00 | 20.240 | 9042130202400 |
| 40 | 25 | 49.5 | 49.5 | 80.5 | 57 | 61.5 | 9049000200140 | 6 | 2.00 | 25.040 | 9042130250400 |
| 40 | 32 | 63 | 80 | 80.5 | 61 | 25.5 | 9049000200140 | 6 | 2.00 | 32.040 | 9042130320400 |
| 50 | 12 | 32 | 49.5 | 80.5 | 46 | 31.5 | 9049000120140 | 5 | 3.50 | 12.050 | 9042130120500 |
| 50 | 20 | 42 | 49.5 | 80.5 | 51 | 34 | 9049000201140 | 6 | 4.00 | 20.050 | 9042130200500 |
| 50 | 20 | 42 | 49.5 | 110 | 51 | 34 | 9049000201140 | 6 | 4.00 | 20.150 | 9042130201500 |
| 50 | 32 | 72 | 72 | 81 | 61 | - | 9049000201140 | 6 | 4.00 | 32.050 | 9042130320500 |