

MAS/BT hydraulic chucks HMC 3000 for clamping small diameters

Product information

- perfect concentricity: $< 3 \mu\text{m}$ at $10 \times d_1$
- balancing quality: G6.3 / 30,000 rev./min
- MAS/BT to JIS B 6339 form AD/B (*: version AD without coolant supply over collar)
- high clamping force
- quick, simple handling and accurate length setting
- IC and GÜHROJET peripheral cooling ensure optimal chip evacuation and tool lubrication

Scope of delivery

- incl. length adjustment screw
- incl. hexagon chuck key Guhring no. 4912
- order pull studs Guhring no. 4927, 4928 separately

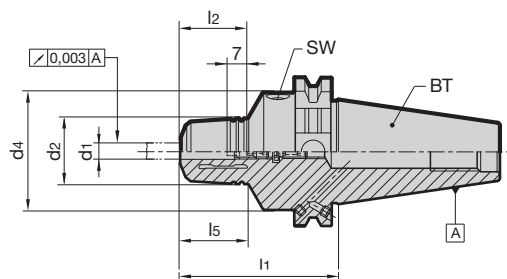

GÜHROJET

Series Number **4620**

| BT | for shank Ø d _{1 h6} mm | d ₂ mm | d ₄ mm | l ₁ mm | l ₂ mm | l ₅ mm | SW | Order Code | EDP Numbers |
|-----|-------------------------------------|-------------------|-------------------|-------------------|-------------------|-------------------|----|------------|---------------|
| 30* | 3 | 28 | - | 55 | 34 | 22.5 | 4 | 3.030 | 9046200030300 |
| 30* | 4 | 28 | - | 55 | 34 | 22.5 | 4 | 4.030 | 9046200040300 |
| 30* | 5 | 28 | - | 55 | 34 | 22.5 | 4 | 5.030 | 9046200050300 |
| 40 | 3 | 28 | 44.5 | 94 | 34 | 48.5 | 5 | 3.040 | 9046200030400 |
| 40 | 4 | 28 | 44.5 | 94 | 34 | 48.5 | 5 | 4.040 | 9046200040400 |
| 40 | 5 | 28 | 44.5 | 94 | 34 | 48.5 | 5 | 5.040 | 9046200050400 |