

## MQL coolant delivery sets HSK-A for the conversion

### Product information

- replace conventional coolant delivery sets, Guhring no. 4949, when applying MQL
- for hydraulic chucks to DIN 69882-7

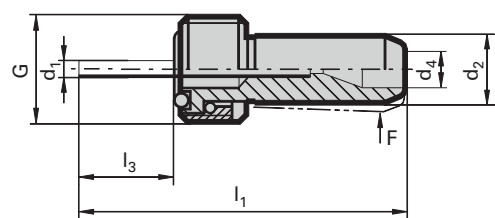

### Scope of delivery

- complete MQL coolant delivery set consisting of :  
coolant pipe, cap nut  
MQL tube and O-rings



Series Number **4924**

for HSK-A	clamping-Ø mm	d <sub>1</sub> mm	d <sub>2</sub> mm	d <sub>4</sub> mm	l <sub>1</sub> mm	l <sub>3</sub> mm	G	EDP Numbers
32	6	2.5	6	3.5	54.2	28.0	M10x1	9049240320100
32	8	3.0	6	3.5	54.3	28.1	M10x1	9049240320300
32	10	3.0	6	3.5	55.8	29.6	M10x1	9049240320500
32	12	3.0	6	3.5	56.6	30.4	M10x1	9049240320700
40	6	2.5	8	4.0	45.1	16.0	M12x1	9049240400100
40	8	3.0	8	4.0	56.2	15.8	M12x1	9049240400300
40	10	3.0	8	4.0	46.3	17.1	M12x1	9049240400500
40	12	3.0	8	4.0	46.7	17.5	M12x1	9049240400700
50	6	2.5	10	4.0	44.6	11.9	M16x1	9049240500100
50	8	3.0	10	4.0	46.1	13.4	M16x1	9049240500300
50	10	4.0	10	4.0	45.7	13.0	M16x1	9049240500500
50	12	5.0	10	4.0	46.1	13.4	M16x1	9049240500700
50	14	5.0	10	4.0	51.5	18.8	M16x1	9049240500900
50	16	5.0	10	4.0	52.8	20.1	M16x1	9049240501100
50	18	5.0	10	4.0	53.2	20.5	M16x1	9049240501300
50	20	5.0	10	4.0	51.5	18.8	M16x1	9049240501500
63	6	2.5	12	4.0	45.7	9.5	M18x1	9049240630100
63	6	2.5	12	4.0	126.9	90.6	M18x1	9049240630110
63	6	2.5	12	4.0	176.9	140.6	M18x1	9049240630120
63	8	3.0	12	4.0	46.0	9.8	M18x1	9049240630300
63	8	3.0	12	4.0	126.1	89.9	M18x1	9049240630310
63	8	3.0	12	4.0	176.2	139.9	M18x1	9049240630320
63	10	4.0	12	4.0	51.7	15.5	M18x1	9049240630500
63	10	4.0	12	4.0	122.2	86.0	M18x1	9049240630510
63	10	4.0	12	4.0	172.2	135.9	M18x1	9049240630520
63	12/14/20	5.0	12	4.0	52.1	15.9	M18x1	9049240630700
63	16/18	5.0	12	4.0	53.8	17.6	M18x1	9049240630900
63	12/14	5.0	12	4.0	117.6	81.4	M18x1	9049240630910
63	12/14	5.0	12	4.0	167.6	131.3	M18x1	9049240630920
63	16	5.0	12	4.0	114.3	78.0	M18x1	9049240631110
63	25/32	6.0	12	4.0	77.0	40.8	M18x1	9049240631200
63	18	5.0	12	4.0	114.6	78.3	M18x1	9049240631310
63	16/18	5.0	12	4.0	164.6	128.3	M18x1	9049240631320
63	20	5.0	12	4.0	112.9	76.6	M18x1	9049240631510
63	20	5.0	12	4.0	162.9	126.6	M18x1	9049240631520
80	6	2.5	14	4.0	44.8	5.5	M20x1.5	9049240800100
80	8	3.0	14	4.0	44.9	5.6	M20x1.5	9049240800300
80	10	4.0	14	4.0	50.9	11.6	M20x1.5	9049240800500
80	12	5.0	14	4.0	51.3	12.0	M20x1.5	9049240800700
80	14	5.0	14	4.0	51.6	12.3	M20x1.5	9049240800900
80	16	5.0	14	4.0	57.9	18.6	M20x1.5	9049240801100
80	18	5.0	14	4.0	58.3	19.0	M20x1.5	9049240801300
80	20	5.0	14	4.0	56.6	17.3	M20x1.5	9049240801500
80	25	6.0	14	4.0	53.1	13.8	M20x1.5	9049240801700
80	32	6.0	14	4.0	77.2	37.9	M20x1.5	9049240801900
100	6	2.5	16	4.0	53.0	9.2	M24x1.5	9049241000100
100	8	3.0	16	4.0	53.7	9.9	M24x1.5	9049241000300
100	10	4.0	16	4.0	63.3	19.5	M24x1.5	9049241000500
100	12	5.0	16	4.0	63.8	20.0	M24x1.5	9049241000700
100	14	5.0	16	4.0	64.2	20.4	M24x1.5	9049241000900
100	16	5.0	16	4.0	65.4	21.6	M24x1.5	9049241001100
100	18	5.0	16	4.0	65.8	22.0	M24x1.5	9049241001300
100	20	5.0	16	4.0	69.2	25.4	M24x1.5	9049241001500
100	25	6.0	16	4.0	68.6	24.8	M24x1.5	9049241001700
100	32	6.0	16	4.0	64.6	20.8	M24x1.5	9049241001900