

Universal length setting adaptor

Product information

- for shrink fit and hydraulic chucks
- for length pre-setting of the setting screw with the cutting tool (less difference dimension l_2 , see sketch)
- flexibly mounted hexagonal key SW1/SW2 (*only available as rigid design)
- with standard screws suitable for wet application Guhring no. 4900, 4941, 4977
- suitable with MQL setting screws Guhring no. 4621, 4919, 4937

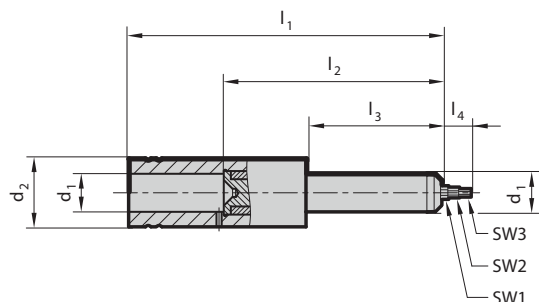

Series Number 4718

| d_1 mm | d_2 mm | l_1 mm | l_2 mm | l_3 mm | l_4 mm | SW1 | SW2 | SW3 | EDP Numbers |
|-------------|-------------|-------------|-------------|-------------|-------------|-----|-----|-----|---------------|
| 6.0 | 25.0 | 115.0 | 80.0 | 50.0 | 10.0 | 2.0 | 1.5 | - | 9047180060010 |
| 6.0 | 25.0 | 115.0 | 80.0 | 50.0 | 10.0 | 3.0 | 2.5 | - | 9047180060000 |
| 6* | 25.0 | 115.0 | 80.0 | 50.0 | 10.0 | 4.0 | - | - | 9047180060020 |
| 8.0 | 25.0 | 115.0 | 80.0 | 50.0 | 10.0 | 2.0 | 1.5 | - | 9047180080010 |
| 8.0 | 25.0 | 115.0 | 80.0 | 50.0 | 10.0 | 3.0 | - | - | 9047180080000 |
| 8* | 25.0 | 115.0 | 80.0 | 50.0 | 10.0 | 4.0 | - | - | 9047180080020 |
| 10.0 | 25.0 | 115.0 | 80.0 | 50.0 | 10.0 | 2.0 | 1.5 | - | 9047180100010 |
| 10.0 | 25.0 | 115.0 | 80.0 | 50.0 | 10.0 | 4.0 | 3.0 | - | 9047180100000 |
| 12.0 | 25.0 | 115.0 | 80.0 | 50.0 | 10.0 | 3.0 | 2.0 | 1.5 | 9047180120010 |
| 12.0 | 25.0 | 115.0 | 80.0 | 50.0 | 10.0 | 5.0 | 4.0 | - | 9047180120000 |
| 14.0 | 25.0 | 115.0 | 80.0 | 50.0 | 10.0 | 3.0 | 2.0 | 1.5 | 9047180140010 |
| 14.0 | 25.0 | 115.0 | 80.0 | 50.0 | 10.0 | 5.0 | 4.0 | - | 9047180140000 |
| 16.0 | 25.0 | 120.0 | 85.0 | 55.0 | 10.0 | 3.0 | 2.0 | 1.5 | 9047180160010 |
| 16.0 | 25.0 | 120.0 | 85.0 | 55.0 | 10.0 | 6.0 | 5.0 | 4.0 | 9047180160000 |
| 18.0 | 30.0 | 120.0 | 85.0 | 55.0 | 10.0 | 3.0 | 2.0 | 1.5 | 9047180180010 |
| 18.0 | 30.0 | 120.0 | 85.0 | 55.0 | 10.0 | 6.0 | 5.0 | 4.0 | 9047180180000 |
| 20.0 | 30.0 | 135.0 | 90.0 | 65.0 | 10.0 | 4.0 | 3.0 | 2.0 | 9047180200010 |
| 20.0 | 30.0 | 135.0 | 90.0 | 65.0 | 10.0 | 8.0 | 5.0 | - | 9047180200000 |
| 25.0 | 35.0 | 140.0 | 100.0 | 70.0 | 10.0 | 4.0 | 3.0 | 2.0 | 9047180250010 |
| 25.0 | 35.0 | 140.0 | 100.0 | 70.0 | 10.0 | 8.0 | 5.0 | - | 9047180250000 |
| 32.0 | 45.0 | 150.0 | 100.0 | 70.0 | 10.0 | 4.0 | 3.0 | 2.0 | 9047180320010 |
| 32.0 | 45.0 | 150.0 | 100.0 | 70.0 | 10.0 | 8.0 | 5.0 | - | 9047180320000 |