

## MAS/BT precision clamping chucks

### Product information

- for heavy-duty cutting as well as HSC and HPC
- MAS/BT to JIS B 6339
- balancing quality G6.3 / 15,000 rev./min
- for tool shank tolerance h6
- highest clamping force and stability thanks to mech. tension gearing
- actuation torque for clamping initiation 12Nm
- suitable for internal cooling up to 80 bar central coolant supply form AD

### Scope of delivery

- hexagon clamping key Guhring no. 4912 4.010
- order clamping sleeves Guhring no. 4302, 4235, 4236, 4237 separately
- for optimal operation order torque wrench 12 Nm Guhring no. 4915 12,0 and sockets Guhring no. 4916 4,0 separately
- form AD/B on request

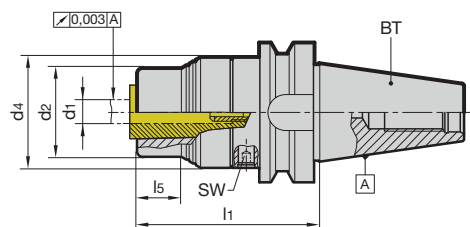

Series Number **4244**

MAS-BT	for clamping-Ø d <sub>1</sub> h6 mm	d <sub>2</sub> mm	d <sub>4</sub> mm	l <sub>1</sub> mm	l <sub>5</sub> mm	SW	Order Code	EDP Numbers
30	3 to 20	40	53	82	20	4	20.030	9042440200300
40	3 to 20	40	63	70	18	4	20.040	9042440200400
40	3 to 20	40	63	120	48	4	120.040	9042441200400
40	20 to 32	56	70	135	3	4	32.040	9042440320400
50	3 to 20	40	63	81	18	4	20.050	9042440200500
50	3 to 20	40	63	167	84	4	120.050	9042441200500
50	20 to 32	56	70	130	3	4	32.050	9042440320500

## CAT precision clamping chucks

### Product information

- for heavy-duty cutting as well as HSC and HPC
- CAT to ANSI B5.50
- balancing quality G6.3 / 15,000 rev./min
- for tool shank tolerance h6
- highest clamping force and stability thanks to mech. tension gearing
- actuation torque for clamping initiation 12Nm
- suitable for internal cooling up to 80 bar
- central coolant supply form AD
- CAT40 d4: does not correspond to ANSI B5.50

### Scope of delivery

- hexagon clamping key Guhring no. 4912 4.010
- order clamping sleeves Guhring no. 4302, 4235, 4236, 4237 separately
- for optimal operation order torque wrench 12 Nm Guhring no. 4915 12.0 and sockets Guhring no. 4916 4.0 separately

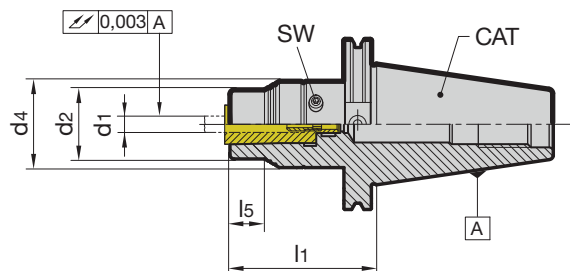

Series Number **4243**

CAT	for clamping-Ø d <sub>1</sub> h6 mm	d <sub>2</sub> mm	d <sub>4</sub> mm	l <sub>1</sub> mm	l <sub>5</sub> mm	SW	Order Code	EDP Numbers
40	3 to 20	40	50	62.5	20	4	20.040	9042430200400
50	3 to 20	40	63	62.0	18	4	20.050	9042430200500
50	20 to 32	56	70	110	3	4	32.050	9042430320500