

MQL hydraulic synchro tapping chucks with internal cooling

Product information

- for MQL single and double channel systems
- MQL coolant pressure up to max. 16 bar
- compensates synchronisation errors
- guarantees high thread quality and optimal tool life
- minimal length compensation in tension and compression direction balances very small pitch differences between synchro spindle and tap
- reduces an increase in axial forces during the cutting cycle to a minimum
- convenient hydraulic clamping using reduction sleeves with active drive
- length-setting screw allows 3 mm readjustment
- holder shank to DIN 1835-A or holding in precision chucks (hydraulic, shrink fit or power clamping chucks)
- Guhring MQL identifiable by green colored ring

Scope of delivery

- incl. hexagon clamping key
Guhring no. 4912
- incl. adjustment key for
MQL adjustment screws
- order MQL adjustment screw
Guhring no. 4305 separately
- order reduction sleeves
Guhring no. 4605 or 4606 separately

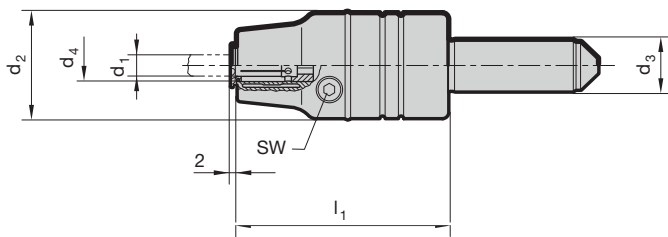

Series Number **4524**

d ₃ h6 mm	d ₄ mm	for shank-Ø d ₁	for thread	d ₂ mm	l ₁ mm	tension/ compr. ± mm	SW	kg	Order Code	EDP Numbers
20	12	2.8 to 10	M3 to M12	40	80	0.3	4	0.7	12.020	9045240120200
20	20	6 to 16	M8 to M20	40	94	0.3	5	0.8	20.020	9045240200200