

Reduction sleeves sealed for hydraulic synchro tapping chucks

Product information

- for clamping taps with square shank in GUHROSync synchro tapping chucks
- clamping-Ø for tool shank tolerance h6-h9
- face side closed, therefore coolant leak-proof for threading tools with IC
- positive drive
- position setting screw on tap shank
- length-setting screw allows 3 mm readjustment

Scope of delivery

- order setting screw
Guhring no. 4364 separately
- order MQL setting screws
Guhring no. 4305 separately

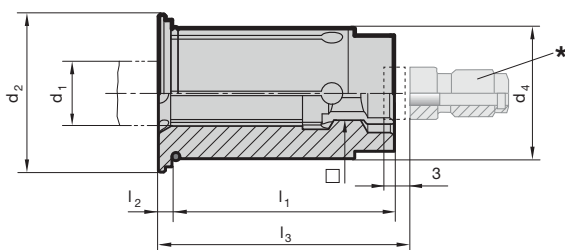

EXCLUSIVELY for
GUHROSync

Series Number **4605**

| d ₄ mm | d ₁ mm | □ mm | Standard | d ₁ inch | □ inch | d ₂ mm | l ₁ mm | l ₂ mm | l ₃ mm | * code for adjustment screw | for thread | Order Code | EDP Numbers |
|----------------------|----------------------|---------|-----------|------------------------|-----------|----------------------|----------------------|----------------------|----------------------|-----------------------------------|-------------------|---------------|---------------|
| 12.00 | 2.800 | 2.100 | DIN | - | - | 16.50 | 29.00 | 2.00 | - | - | M2 / M4 | 2.812 | 9046050028120 |
| 12.00 | 3.500 | 2.700 | DIN | - | - | 16.50 | 29.00 | 2.00 | - | - | M3 / M4.5 / M5 | 3.512 | 9046050035120 |
| 12.00 | 4.000 | 3.200 | JIS | - | - | 16.50 | 29.00 | 2.00 | - | - | M3 | 4.012 | 9046050040120 |
| 12.00 | 4.500 | 3.400 | DIN | - | - | 16.50 | 29.00 | 2.00 | 26.00 | 4364 5.020 | M4 / M6 | 4.512 | 9046050045120 |
| 12.00 | 4.928 | 3.861 | ANSI | 0.194 | 0.152 | 16.50 | 29.00 | 2.00 | 26.00 | 4364 5.020 | 10-24 & 10-32 | 4.912 | 9046050049120 |
| 12.00 | 5.000 | 4.000 | JIS | - | - | 16.50 | 29.00 | 2.00 | 26.00 | 4364 5.020 | M4 | 5.012 | 9046050050120 |
| 12.00 | 5.500 | 4.500 | JIS | - | - | 16.50 | 29.00 | 2.00 | 26.00 | 4364 5.020 | M5 | 5.512 | 9046050055120 |
| 12.00 | 5.588 | 4.191 | ANSI | 0.220 | 0.165 | 16.50 | 29.00 | 2.00 | 26.00 | 4364 5.020 | 12-24 & 12-28 | 15.512 | 9046050155120 |
| 12.00 | 6.000 | 4.500 | JIS | - | - | 16.50 | 29.00 | 2.00 | 26.00 | 4364 5.020 | M6 | 16.012 | 9046050160120 |
| 12.00 | 6.000 | 4.900 | DIN | - | - | 16.50 | 29.00 | 2.00 | 26.00 | 4364 6.020 | M4.5/M5/M6/M8 | 6.012 | 9046050060120 |
| 12.00 | 6.200 | 5.000 | JIS | - | - | 16.50 | 29.00 | 2.00 | 26.00 | 4364 6.020 | M7 / M8 | 6.212 | 9046050062120 |
| 12.00 | 6.477 | 4.851 | ANSI | 0.255 | 0.191 | 16.50 | 29.00 | 2.00 | 26.00 | 4364 6.020 | 1/4-20 & 1/4-28 | 6.412 | 9046050064120 |
| 12.00 | 7.000 | 5.500 | DIN / JIS | - | - | 16.50 | 29.00 | 2.00 | 26.00 | 4364 7.020 | M7 / M9 / M10 | 7.012 | 9046050070120 |
| 12.00 | 7.938 | 5.944 | ANSI | 0.3125 | 0.234 | 16.50 | 29.00 | 2.00 | 31.00 | 4364 7.020 | 1/16-27 | 7.912 | 9046050079120 |
| 12.00 | 8.000 | 6.200 | DIN | - | - | 16.50 | 29.00 | 2.00 | 31.00 | 4364 8.020 | M8 / M11 | 8.012 | 9046050080120 |
| 12.00 | 8.000 | 6.500 | JIS | - | - | 16.50 | 29.00 | 2.00 | 31.00 | 4364 8.020 | M11 | 18.012 | 9046050180120 |
| 12.00 | 8.077 | 6.045 | ANSI | 0.318 | 0.238 | 16.50 | 29.00 | 2.00 | 31.00 | 4364 7.020 | 5/16-18 & 5/16-24 | 28.012 | 9046050280120 |
| 12.00 | 8.204 | 6.147 | ANSI | 0.323 | 0.242 | 16.50 | 29.00 | 2.00 | 31.00 | 4364 7.020 | 7/16-14 & 7/16-20 | 8.212 | 9046050082120 |
| 12.00 | 8.500 | 6.500 | JIS | - | - | 16.50 | 29.00 | 2.00 | 31.00 | 4364 8.020 | M12 | 8.512 | 9046050085120 |
| 12.00 | 9.000 | 7.000 | DIN | - | - | 16.50 | 29.00 | 2.00 | 32.00 | 4364 9.020 | M9 / M12 | 9.012 | 9046050090120 |
| 12.00 | 9.322 | 6.985 | ANSI | 0.367 | 0.275 | 16.50 | 29.00 | 2.00 | 32.00 | 4364 9.020 | 1/2-13 & 1/2-20 | 9.312 | 9046050093120 |
| 12.00 | 9.677 | 7.264 | ANSI | 0.381 | 0.286 | 16.50 | 29.00 | 2.00 | 33.00 | 4364 9.020 | 3/8-16 & 3/8-24 | 9.612 | 9046050096120 |
| 12.00 | 10.000 | 8.000 | DIN | - | - | 16.50 | 29.00 | 2.00 | 36.00 | 4364 10.020 | M10 | 10.012 | 9046050100120 |