

GUHROJET reduction sleeves for hydraulic synchro tapping chucks

Product information

- for clamping taps with square shank in GUHROSync synchro tapping chucks
- clamping-Ø for tool shank tolerance h6-h9
- positive drive of reduction bush in Guhrosync synchro chuck
- with coolant slots for peripheral cooling, therefore process and tool life improvement
- coiled swarf is consistently washed away
- position setting screw on tap shank
- length-setting screw allows 3 mm readjustment

Scope of delivery

- order setting screw
Guhring no. 4364 separately
- order MQL setting screws
Guhring no. 4305 separately

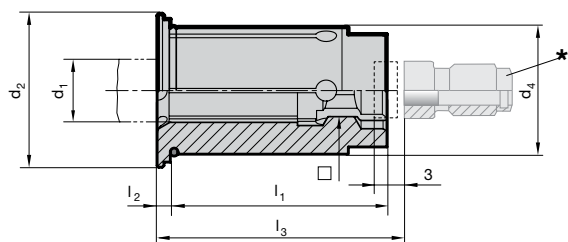

GUHROJET

EXCLUSIVELY for

GUHROSync

Series Number **4606**

d ₄ mm	d ₁ mm	□ mm	Standard	d ₁ inch	□ inch	d ₂ mm	l ₁ mm	l ₂ mm	l ₃ mm	* code for adjustment screw	for thread	Order Code	EDP Numbers
12.00	2.800	2.100	DIN	-	-	16.50	29.00	2.00	-	-	M2 / M4	2.812	9046060028120
12.00	3.500	2.700	DIN	-	-	16.50	29.00	2.00	-	-	M3 / M4.5 / M5	3.512	9046060035120
12.00	3.581	2.794	ANSI	0.1410	0.110	16.50	29.00	2.00	-	-	2-56 to 6-40	3.612	9046060036120
12.00	4.000	3.200	JIS	-	-	16.50	29.00	2.00	-	-	M3	4.012	9046060040120
12.00	4.268	3.327	ANSI	0.1680	0.131	16.50	29.00	2.00	-	-	8-32 & 8-36	4.312	9046060043120
12.00	4.500	3.400	DIN	-	-	16.50	29.00	2.00	-	-	M4 / M6	4.512	9046060045120
12.00	4.928	3.861	ANSI	0.194	0.152	16.50	29.00	2.00	-	-	10-24 & 10-32	4.912	9046060049120
12.00	5.000	4.000	JIS	-	-	16.50	29.00	2.00	-	-	M4	5.012	9046060050120
12.00	5.500	4.500	JIS	-	-	16.50	29.00	2.00	-	-	M5	5.512	9046060055120
12.00	5.588	4.191	ANSI	0.220	0.165	16.50	29.00	2.00	-	-	12-24 & 12-28	15.512	9046060155120
12.00	6.000	4.500	JIS	-	-	16.50	29.00	2.00	26.00	6.020	M6	16.012	9046060160120
12.00	6.000	4.900	DIN	-	-	16.50	29.00	2.00	26.00	6.020	M4.5/M5/M6/M8	6.012	9046060060120
12.00	6.200	5.000	JIS	-	-	16.50	29.00	2.00	26.00	6.020	M7 / M8	6.212	9046060062120
12.00	6.477	4.851	ANSI	0.255	0.191	16.50	29.00	2.00	26.00	6.020	1/4-20 & 1/4-28	6.412	9046060064120
12.00	7.000	5.500	DIN / JIS	-	-	16.50	29.00	2.00	26.00	7.020	M7 / M9 / M10	7.012	9046060070120
12.00	7.938	5.944	ANSI	0.3125	0.234	16.50	29.00	2.00	31.00	7.020	1/16-27	7.912	9046060079120
12.00	8.000	6.200	DIN	-	-	16.50	29.00	2.00	31.00	8.020	M8 / M11	8.012	9046060080120
12.00	8.000	6.500	JIS	-	-	16.50	29.00	2.00	31.00	8.020	M11	18.012	9046060180120
12.00	8.077	6.045	ANSI	0.318	0.238	16.50	29.00	2.00	31.00	7.020	5/16-18 & 5/16-24	28.012	9046060280120
12.00	8.204	6.147	ANSI	0.323	0.242	16.50	29.00	2.00	31.00	8.020	7/16-14 & 7/16-20	8.212	9046060082120
12.00	8.500	6.500	JIS	-	-	16.50	29.00	2.00	31.00	8.020	M12	8.512	9046060085120
12.00	9.000	7.000	DIN	-	-	16.50	29.00	2.00	32.00	9.020	M9 / M12	9.012	9046060090120
12.00	9.322	6.985	ANSI	0.367	0.275	16.50	29.00	2.00	32.00	9.020	1/2-13 & 1/2-20	9.312	9046060093120
12.00	9.677	7.264	ANSI	0.381	0.286	16.50	29.00	2.00	33.00	9.020	3/8-16 & 3/8-24	9.612	9046060096120
12.00	10.000	8.000	DIN	-	-	16.50	29.00	2.00	36.00	10.020	M10	10.012	9046060100120