

## Kurzklemmhalter KV 400

60°

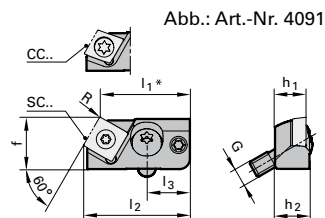
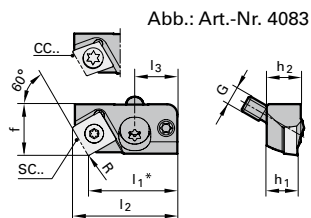

\* I1: theoretischer Schnittpunkt

Bestell-Nr. = Artikel-Nr. + Code-Nr.	Größe	f mm	für WSP	I1* mm	I2 mm	I3 mm	G mm	h1 mm	h2 mm	R	Dmin	Stückpreis in € Rabattgruppe 122
4083 6,000	06	9,5	CC..0602..	19,5	22,72	9,85	M3,5	6,3	7,3	0,2	26,0	103,00
4083 9,000	09	15,0	SC..09T3..	26,0	30,76	12,5	M5	9,0	10,0	0,4	36,0	108,00
4083 12,000	12	20,0	SC..1204..	34,0	40,35	16,1	M6	10,5	11,5	0,4	42,0	113,00
4091 6,000	06	9,5	CC..0602..	19,5	22,72	9,85	M3,5	6,3	7,3	0,2	26,0	103,00
4091 9,000	09	15,0	SC..09T3..	26,0	30,76	12,5	M5	9,0	10,0	0,4	36,0	108,00
4091 12,000	12	20,0	SC..1204..	34,0	40,35	16,1	M6	10,5	11,5	0,4	42,0	113,00

75°

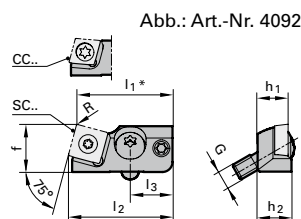
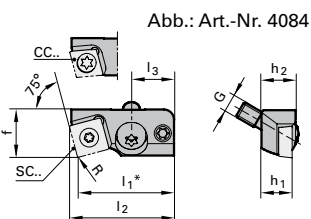

\* I1: theoretischer Schnittpunkt

Bestell-Nr. = Artikel-Nr. + Code-Nr.	Größe	f mm	für WSP	I1* mm	I2 mm	I3 mm	G mm	h1 mm	h2 mm	R	Dmin	Stückpreis in € Rabattgruppe 122
4084 6,000	06	9,5	CC..0602.. R/N	20,0	21,76	9,85	M3,5	6,3	7,3	0,2	31,0	103,00
4084 9,000	09	14,0	SC..09T3.. L/N	28,0	30,66	12,5	M5	9,0	10,0	0,4	41,0	108,00
4084 12,000	12	19,0	SC..1204.. L/N	36,0	39,48	16,1	M6	10,5	11,5	0,4	49,0	113,00
4092 6,000	06	9,5	CC..0602.. L/N	20,0	21,76	9,85	M3,5	6,3	7,3	0,2	31,0	103,00
4092 9,000	09	14,0	SC..09T3.. R/N	28,0	30,66	12,5	M5	9,0	10,0	0,4	41,0	108,00
4092 12,000	12	19,0	SC..1204.. R/N	36,0	39,48	16,1	M6	10,5	11,5	0,4	49,0	113,00

90°

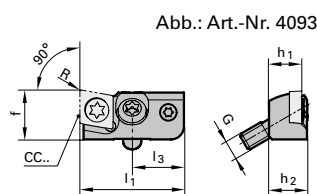
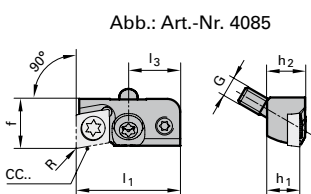

Bestell-Nr. = Artikel-Nr. + Code-Nr.	Größe	f mm	für WSP	I1 mm	I2 mm	I3 mm	G mm	h1 mm	h2 mm	R	Dmin	Stückpreis in € Rabattgruppe 122
4085 6,000	06	9,5	CC..0602.. L/N	20,0	20,0	9,85	M3,5	6,3	7,3	0,2	26,0	103,00
4085 9,000	09	14,0	CC..09T3.. L/N	28,0	28,0	12,5	M5	9,0	10,0	0,4	36,0	108,00
4085 12,000	12	19,0	CC..1204.. L/N	36,0	36,0	16,1	M6	10,5	11,5	0,4	42,0	113,00
4093 6,000	06	9,5	CC..0602.. R/N	20,0	20,0	9,85	M3,5	6,3	7,3	0,2	26,0	103,00
4093 9,000	09	14,0	CC..09T3.. R/N	28,0	28,0	12,5	M5	9,0	10,0	0,4	36,0	108,00
4093 12,000	12	19,0	CC..1204.. R/N	36,0	36,0	16,1	M6	10,5	11,5	0,4	42,0	113,00

für Sonder-  
formplatten

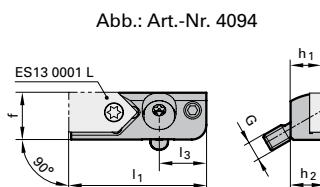
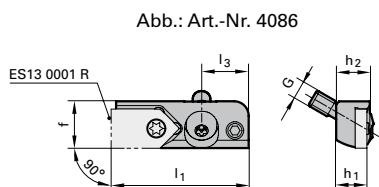

Bestell-Nr. = Artikel-Nr. + Code-Nr.	Größe	f mm	für WSP	I1 mm	I2 mm	I3 mm	G mm	h1 mm	h2 mm	R	Dmin	Stückpreis in € Rabattgruppe 122
4086 13,000	13	16,0	ES13 0001 N	47,0	-	16,1	M6	10,5	11,5	-	42,0	118,00
4094 13,000	13	16,0	ES13 0001 N	47,0	-	16,1	M6	10,5	11,5	-	42,0	118,00