

EXCLUSIVE[®]LINE

CAT hydraulic chucks

Product information

- balancing quality: G6.3 / 15,000 rev./min
- taper according to ANSI/ASME B 5.50
- coolant through center and also through flange (plugged with set screws when supplied)
- axial length setting
- CAT 40 - 5/8 x 11 retention knob thread
- CAT 50 - 1" x 8 retention knob thread

Scope of delivery

- incl. setting screw, Guhring no. 4900
- incl. hex wrench, Guhring no. 4912
- special dimensions on request

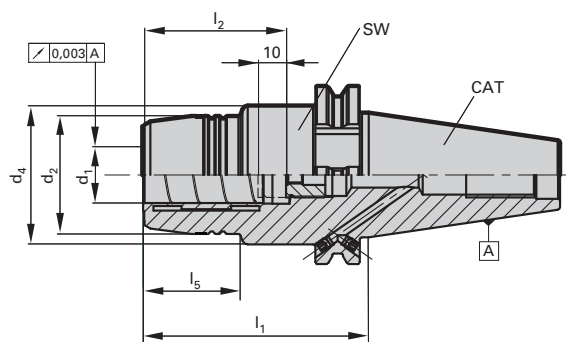

Series Number **4216**

CAT	for shank Ø d ₁ h6 mm	d ₂ mm	d ₄ mm	l ₁ mm	l ₂ mm	l ₅ mm	incl. setting screw 4900 ...	SW	kg	Code no.	EDP
40	20	42.0	44.5	64.0	51.0	34.0	20.114	5	1.12	20.040	9042160200400
40	25	49.5	44.5	81.0	57.0	40.0	20.114	6	1.34	25.040	9042160250400
40	32	63.0	80.0	81.0	61.0	25.5	20.114	6	1.90	32.040	9042160320400
50	20	42.0	69.9	81.0	51.0	34.0	20.114	5	3.42	20.050	9042160200500
50	25	57.0	69.9	81.0	57.0	40.0	20.114	6	3.62	25.050	9042160250500
50	32	63.0	69.9	81.0	61.0	45.0	20.114	6	3.61	32.050	9042160320500