

H Side milling cutters

axial μm -accurate adjustable

Type 3108 and 6120 $\varnothing D 125 - \varnothing D 160$

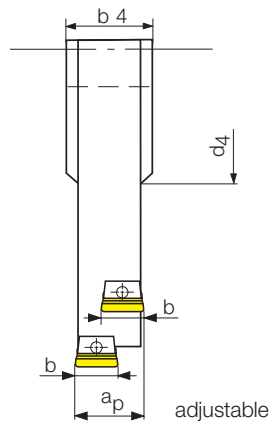

Part nr. 20003	Code	Drawing nr.	$\varnothing D$	z	z_{eff}	a_p	b	a_{max}	d_3	d_4	b_4	Inserts
	125,000	H 3108-1250 0840 N	○ 125	18	9	8	7.8	30	40	58	10	W 3108-... N
	125,001	H 3108-1250 1040 N	○ 125	18	9	10	7.8	30	40	58	12	↓
	125,002	H 3108-1250 1240 N	○ 125	18	9	12	7.8	30	40	58	14	↓
	125,003	H 3108-1250 1440 N	○ 125	18	9	14	7.8	30	40	58	16	↓
	125,004	H 6120-1250 1240 N	○ 125	14	7	12.2	12 / 7*	30	40	58	14	W 612...N/R/L
	125,005	H 6120-1250 1440 N	○ 125	14	7	14	12 / 7*	30	40	58	16	↓
	125,006	H 6120-1250 1640 N	○ 125	14	7	16	12 / 7*	30	40	58	18	↓
	125,007	H 6120-1250 1840 N	○ 125	14	7	18	12 / 7*	30	40	58	20	↓
	125,008	H 6120-1250 2040 N	○ 125	14	7	20	12 / 7*	30	40	58	22	↓
	160,000	H 3108-1600 0840 N	○ 160	22	11	8	7.8	44	40	58	10	W 3108-... N
	160,001	H 3108-1600 1040 N	○ 160	22	11	10	7.8	44	40	58	12	↓
	160,002	H 3108-1600 1240 N	○ 160	22	11	12	7.8	44	40	58	14	↓
	160,003	H 3108-1600 1440 N	○ 160	22	11	14	7.8	44	40	58	16	↓

* PCD-inserts with cutting length of 7 mm see page 20

Special measurements e.g. from 5 mm onward can be delivered on request

○ in short time available

Ordering example: 1 piece H 3108-1250 0840 N = Ordering number: 20003 125,000



Spare parts
page 45



Form „Request
for customer
specific tools“
page 130

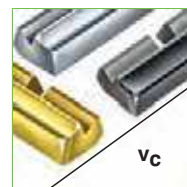

Geometry and
grade selection
pages 37-39