

# Fineboring tools

Tapered screw adjustment  $\mu\text{m}$ -accurate adjustable

1 cutting edge  $\varnothing 6 - 13 \text{ mm}$   
internal coolant

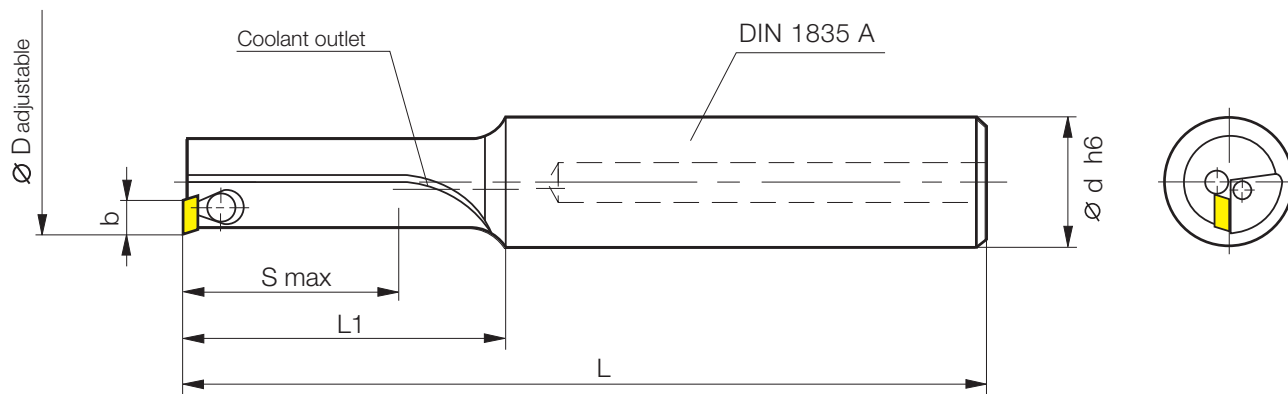

Part nr. 20011									
Code	Drawing nr.		b	$\varnothing D$	$\varnothing d$	S	L <sub>1</sub>	L	Inserts
6,200	H 1730-0620 1512 R	●	3	5.9 - 6.1	12	15	25	70	W 1730-... L
			3.25	6.4 - 6.6	→				W 1733-... L
7,200	H 1730-0720 1512 R	●	3	6.9 - 7.1	12	15	25	70	W 1730-... L
			3.25	7.4 - 7.6	→				W 1733-... L
8,200	H 1730-0820 2012 R	●	3	7.9 - 8.1	12	20	30	75	W 1730-... L
			3.25	8.4 - 8.6	→				W 1733-... L
9,200	H 1730-0920 2012 R	●	3	8.9 - 9.1	12	20	30	75	W 1730-... L
			3.25	9.4 - 9.6	→				W 1733-... L
10,200	H 2850-1020 2516 R	●	5	9.7 - 10.3	16	25	35	83	W 2850-...L
			5.25	10.2 - 10.8	→				W 2853-...L
11,200	H 2850-1120 2516 R	●	5	10.7 - 11.3	16	25	35	83	W 2850-...L
			5.25	11.2 - 11.8	→				W 2853-...L
12,200	H 2850-1220 3016 R	●	5	11.7 - 12.3	16	30	40	88	W 2850-...L
			5.25	12.2 - 12.8	→				W 2853-...L
13,200	H 2850-1320 3016 R	●	5	12.7 - 13.3	16	30	40	88	W 2850-...L
			5.25	13.2 - 13.8	→				W 2853-...L

● ex stock

Ordering example: 1 piece H 1730-0620 1512 R = Ordering number: 20011 6,200



Spare parts  
page 56



Geometry and  
grade selection  
pages 75-76