

Inserts precision ground for fineboring tools and cartridges

Insert W 2853-.... L

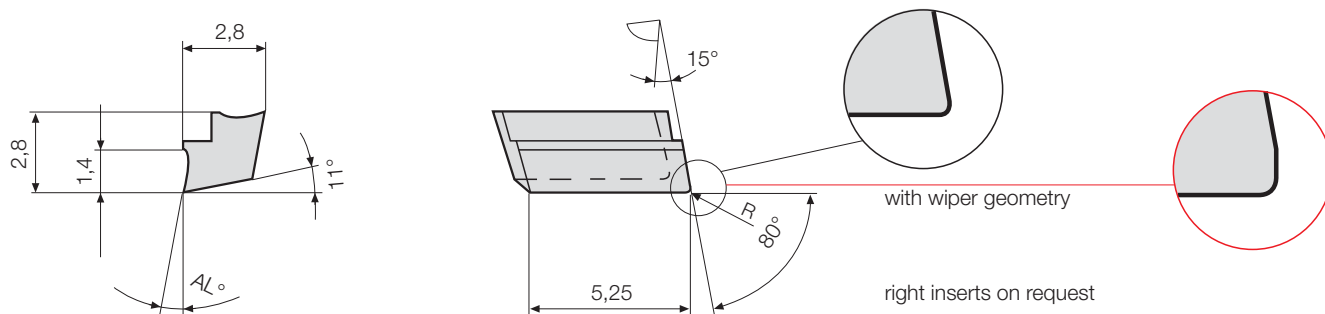

				Part nr. 20160	Part nr. 20161 uncoated	Part nr. 20162	Part nr. 20440	Part nr. 20442 coated	Part nr. 20444
Code	Drawing nr.	R	AL°	P10	P40	K10	G12	G16	G26
28,530	W 2853-0214 1000 L	0,2	10	●	●	●	●	●	●
28,531	W 2853-0414 1000 L	0,4	10	●	●	●	●	●	●
28,532	W 2853-0214 1620 L	0,2	16	○	●	●	●	○	●
28,533	W 2853-0414 1620 L	0,4	16	○	●	●	●	○	●

				Part nr. 20166	Part nr. 20167 uncoated	Part nr. 20168	Part nr. 20445	Part nr. 20447 coated	Part nr. 20449
Code	Drawing nr.	R	AL°	P10	P40	K10	G12	G16	G26
28,530	W 2853-0214 1011 L	0,2	10	●	●	●	●	●	●
28,531	W 2853-0414 1011 L	0,4	10	●	●	●	●	●	●
28,532	W 2853-0214 1611 L	0,2	16	○	●	●	●	○	●
28,533	W 2853-0414 1611 L	0,4	16	○	●	●	●	○	●

				Part nr. 20172	Part nr. 20173
Code	Drawing nr.	R	AL°	PKD	CBN
28,530	W 2853-0000 0000 L	0,05	0	●	
28,531	W 2853-0200 0000 L	0,2	0	●	●
28,532	W 2853-0400 0000 L	0,4	0	●	●

				Part nr. 20174
Code	Drawing nr.	R	AL°	PKD
28,530	W 2853-0000 0011 L	0,05	0	●
28,531	W 2853-0200 0011 L	0,2	0	●
28,532	W 2853-0400 0011 L	0,4	0	●

● ex stock ○ on request

Ordering example: 1 piece W 2853-0214 1000 L G12 = Ordering number: 20440 28,530

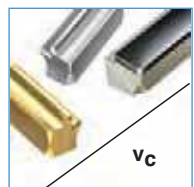

Grade selections
and insert
geometries
pages 75-76

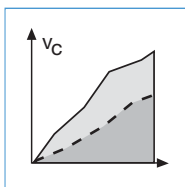

Application
recommendations
page 77



Insert
PCD-fullface
W 2853-.... L